

Uncrating and Assembly Instructions

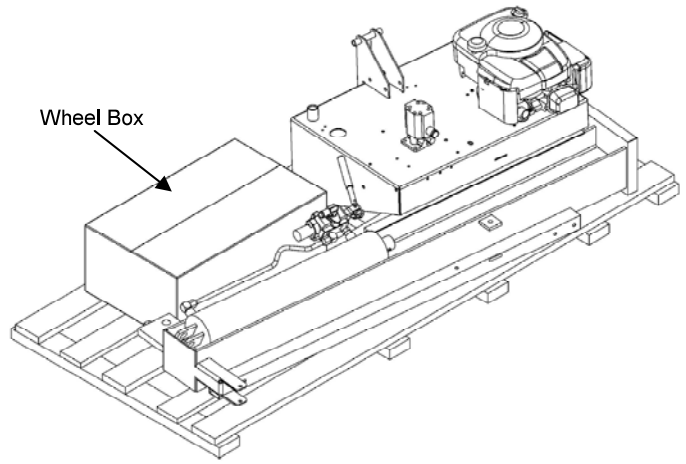

Step 1: Uncrating

- Remove the top 4 boards
- Remove the 2 sides and 2 ends

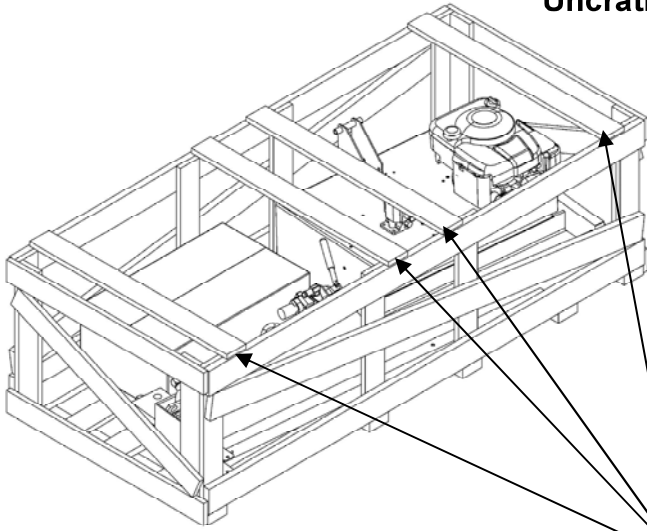
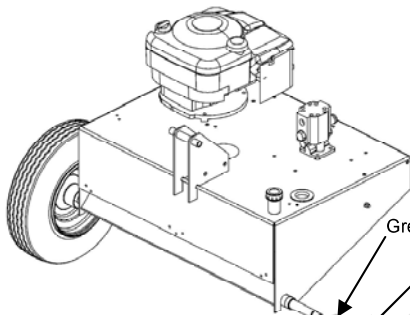

Step 2: Wheel Installation

- Remove contents from Wheel Box.
- Assemble the wheels to the Motor Base as shown.
- Align one set of slots in the Castle Nut to the hole on the shaft. Slide the Cotter Pin, (NB633) through the hole and bend one side of the cotter pin to lock the castle nut into place.
- Align the dust cover with the inside surface of the wheel. Using a piece of wood, gently tap the cover into place.

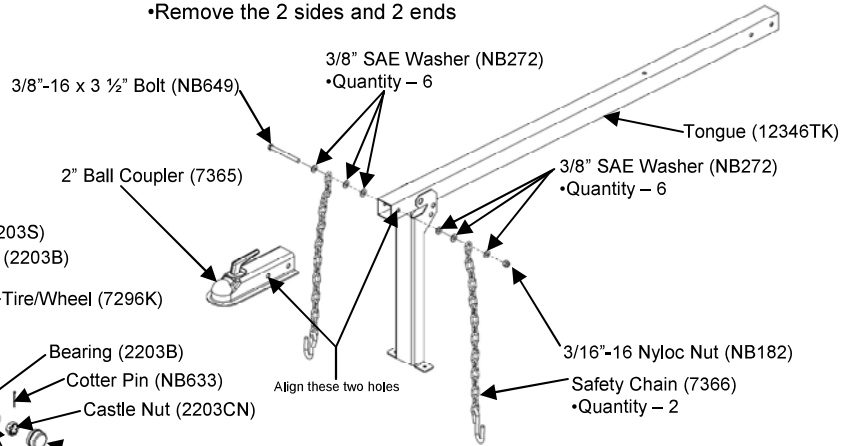
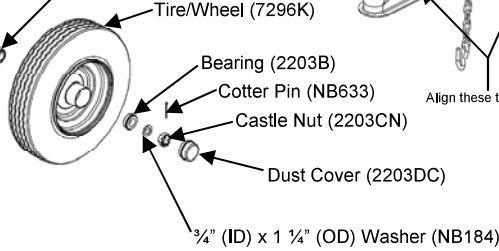

Step 3: Ball Coupler Assembly

- Assemble coupler to tongue as shown (install only one bolt as shown).

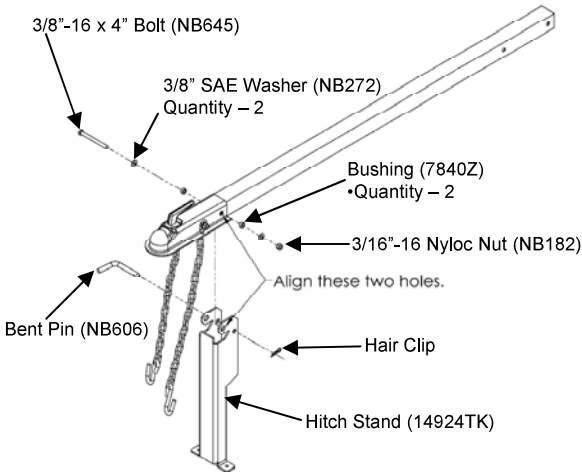

Step 4: Hitch Stand Assembly

- Install hitch to tongue assembly as shown.
- Tighten all nuts to 30 ft-lbs torque.

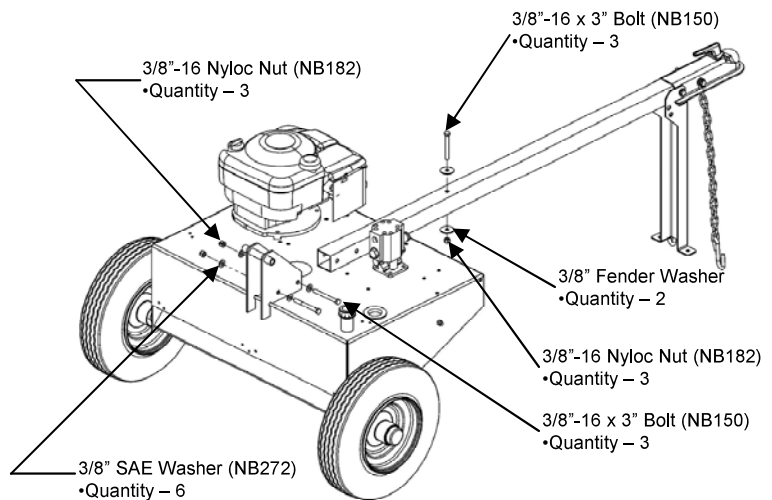

Step 5: Tongue Installation

- Attach assembled tongue to motor base as shown.
- Tighten all nuts to 30 ft-lbs torque.

Step 6: Beam Installation

- Set Beam in Vertical position as shown.
- Push assembled motor base to align pivot tube to tabs located on the bottom of the beam.
- Install hardware as shown.

•**Note:** Tighten nut so that the threads engage in the nylon part of the nut. Bolt & nut should be left loose enough to allow beam to pivot freely.

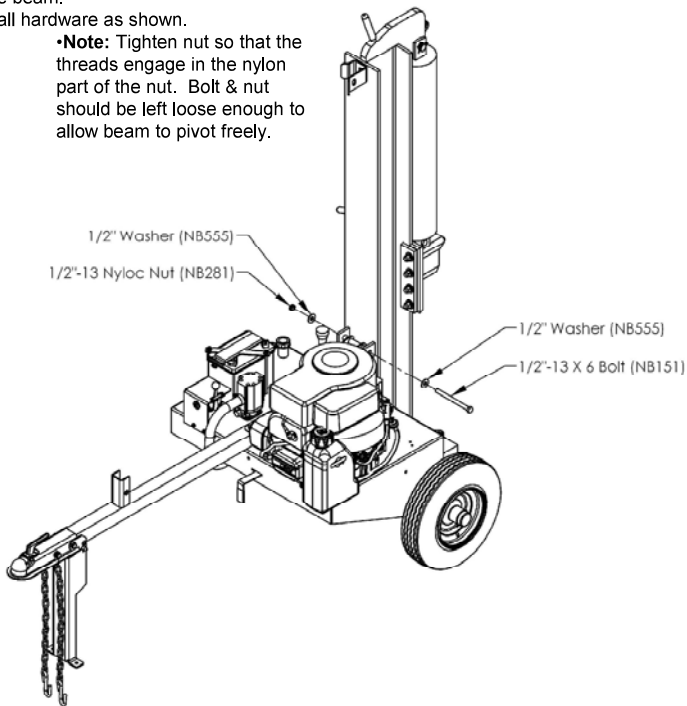

Step 7: Placing Beam in Horizontal Position

- Carefully rotate beam down onto the tongue as shown.
- Secure the beam in place using the hardware provided.

•**Note:** See "Step 7 Detail" for hardware assembly.

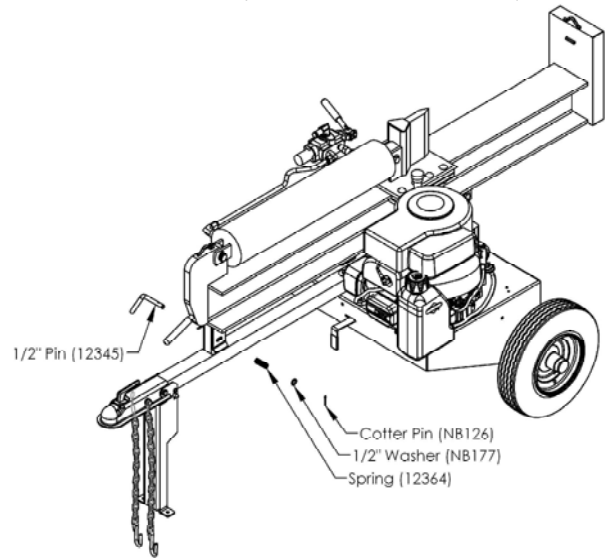

Step 7 Detail

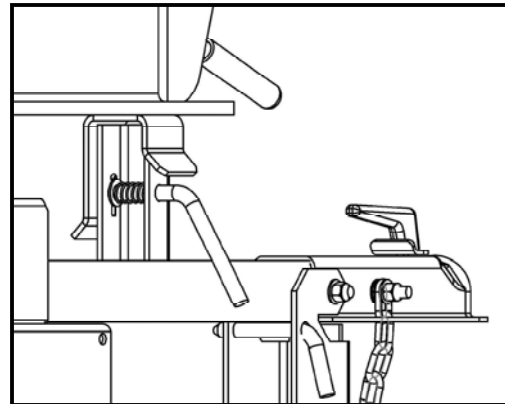

Hose Configuration

